

# Fluid control valve(2/2way)

## 2S Series (Direct-acting and normally closed)

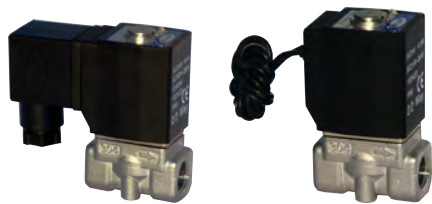

### Symbol



### Product feature

1. Direct acting and normally closed type 2/2 way solenoid valve. Its high sensibility allows it to change direction quickly;
2. It has wide pressure range, including extra high pressure (X), high pressure (H), standard, large volume(L) and extra large volume (T) to choose from;
3. It is compact, small size and light weight. It is easy to install and dismantle.
4. The valve body is made of SUS304. Its coil has a Heat resistance classification of Class B. The standard seal material is FPM-F. Please contact us if other material are required.
5. The protection class of the coil is IP65 and there is a choice for grommet or terminal electrical entry.

### Inner structure

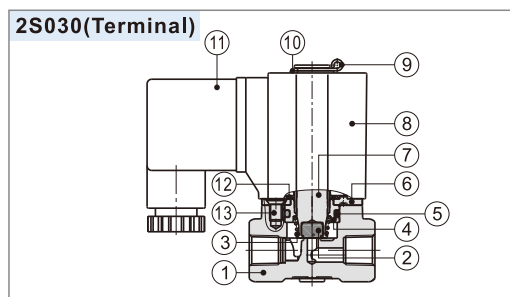

No.	Item	No.	Item
1	Body	8	Coil assembly
2	Airtight ring	9	E Clip
3	Spring	10	Gasket
4	Fixed cap	11	Connector
5	O-ring	12	Washer
6	Fixed plate	13	Screw
7	Movable core		

### Specification

Model\Item	Port size [Note1]	Orifice size (Φmm)	Cv	Valid area or section (mm <sup>2</sup> )	Weight [Note2](g)	Max.operating pressure differentia		Proof pressure	
						MPa	psi	MPa	psi
2SX030	-06	1/8"	1.5	0.10	1.8	3.0	450	5.0	750
	-08	1/4"							
2SH030	-06	1/8"	2.0	0.18	3.0	2.0	300	5.0	750
	-08	1/4"							
2S030	-06	1/8"	3.0	0.33	6.0	1.0	150	5.0	750
	-08	1/4"							
2SL030	-06	1/8"	4.0	0.55	10.0	0.5	75	5.0	750
	-08	1/4"							
2ST030	-06	1/8"	6.0	1.10	12.0	0.1	15	5.0	750
	-08	1/4"							
2SX050	-10	3/8"	3.0	0.34	6.1	3.0	450	5.0	750
	-15	1/2"							
2SH050	-10	3/8"	4.0	0.55	10.0	2.0	300	5.0	750
	-15	1/2"							
2S050	-10	3/8"	5.0	0.83	15.0	1.0	150	5.0	750
	-15	1/2"							
2SL050	-10	3/8"	7.0	1.40	25.0	0.5	75	5.0	750
	-15	1/2"							
2ST050	-10	3/8"	10.0	2.20	40.0	0.1	15	5.0	750
	-15	1/2"							

[Note1] G thread is available.

[Note2] The weight in the table is the terminal valve's weight, 2S030 series grommet valve's weight is 10g less than terminal's. 2S050series grommet valve's weight is 20g less than terminal's.

### Specification of coil

Valve type	Coil type	Power type	Frequency (Hz)	Voltage range	Electrical entry	Power Consumption (VA/W)	Insulation	Temp. rise(°C)		
2S□030	CDA116 CLA116	AC	50	± 15%	Terminal (CDA)	10.0VA	Class B	35		
			60			8.0VA		30		
2S□050	CDA170 CLA170	AC	50	± 15%		Grommet (CLA)		25.0VA	Class B	60
			60					22.0VA		55
		DC	-	± 10%		12.0W		40		

### Valve's specification

Acting		Direct acting				
Initial state		Normally closed				
Adaptable fluid		Air, Water, Oil				
Viscosity limit		Under 20CST				
Ambient and fluid temperature ( °C )			Water	Air	Oil	Ambient
		Max.	80	90	80	70
		Min.	1	-20 [Note1]	-10 [Note2]	-20

[Note1] Dew point: -20(°C) or less;

[Note2] 50CST or less.

### Ordering code

#### Ordering code of valves

2S L 030 08 A □ G

① ② ③ ④ ⑤ ⑥ ⑦

① Model	② Pressure condition	③ Size series	④ Port size	⑤ Voltage	⑥ Electrical entry	⑦ Thread type
2S: 2/2 way direct-acting and normally closed	X: Extra high pressure H: High pressure Blank: Standard L: Large volume T: Extra large volume	030: 030 Series  050: 050 Series	06: 1/8" 08: 1/4"  10: 3/8" 15: 1/2"	A: AC220V B: DC24V C: AC110V E: AC24V F: DC12V	Blank: Terminal I: Grommet[Note]	G: G Thread

#### Ordering code of accessories

F-2S030 LB

① ② ③

① Accessories code	② Valve type	③ Accessories type
F: Mounting accessories	2S030: 030 Series valve 2S050: 050 Series valve	LB: LB Type

[Note] The wire length is 0.5m.

# Fluid control valve(2/2way)

## 2S Series (Direct-acting and normally closed)

### Flow chart

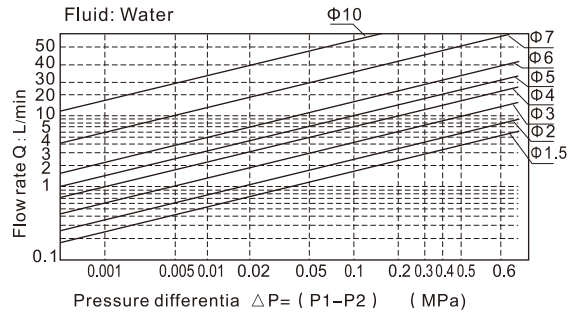
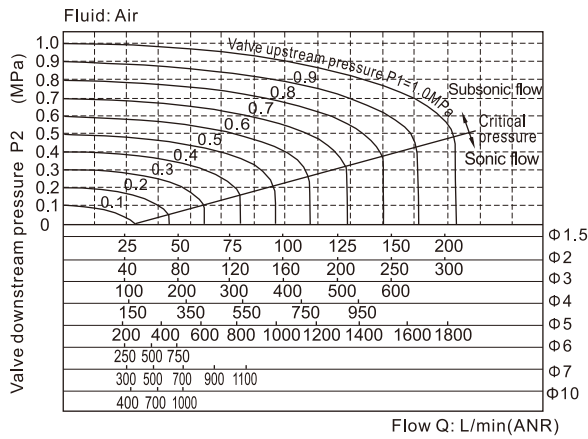

### Dimensions

#### 2S□030 (Terminal)

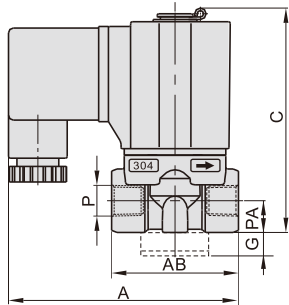
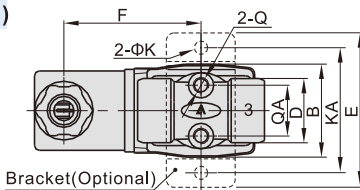

#### 2S□030 (Grommet)

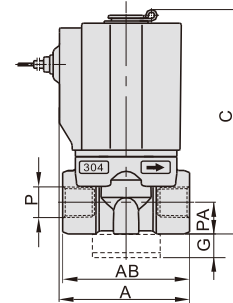
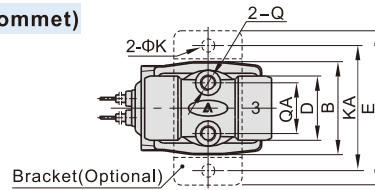

#### 2S□050 (Terminal)

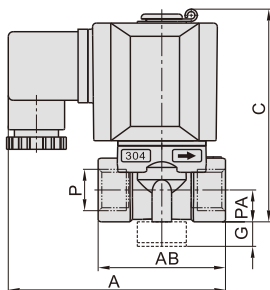
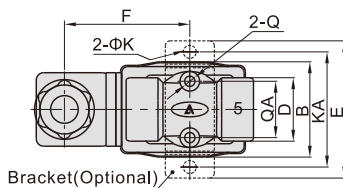

#### 2S□050 (Grommet)

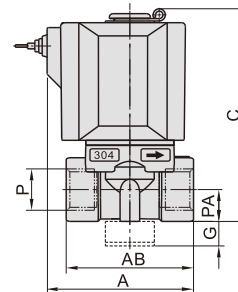
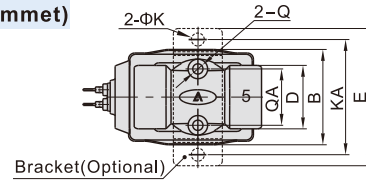

Model\Item	A	AB	B	C	D	E	F	G	K	KA	P	PA	Q	QA
2S□030-06	72.5	40	29.5	71	20	49	43.5	10	5.3	40	1/8"	10	M5	16
2S□030-08	72.5	40	29.5	71	20	49	43.5	10	5.3	40	1/4"	10	M5	16
2S□050-10	89.5	52	39	87	26	56	51	10	5.3	48	3/8"	13	M5	23
2S□050-15	89.5	52	39	87	26	56	51	10	5.3	48	1/2"	13	M5	23

Model\Item	A	AB	B	C	D	E	G	K	KA	P	PA	Q	QA
2S□030-06	41	40	29.5	71	20	49	10	5.3	40	1/8"	10	M5	16
2S□030-08	41	40	29.5	71	20	49	10	5.3	40	1/4"	10	M5	16
2S□050-10	60	52	39	87	26	56	10	5.3	48	3/8"	13	M5	23
2S□050-15	60	52	39	87	26	56	10	5.3	48	1/2"	13	M5	23